

Change Bulletin

No: CB004

Rev: 0

Date: Jan. 12, 2007



Tesco Corporation
6204 – 6A Street SE
Calgary, AB. T2H 2B7
Phone: (403) 692 5700
www.tescocorp.com

Description: EMI 400 Load Collar Update

BACKGROUND INFORMATION:

In order to provide better stabilization of the EMI 400 load collar (PN 13392), two bolts have been added to the load collar to provide a bearing point against the upper grabber leg. Figure 1 below shows the location of these bolts. The modification includes the addition of two 1/2" UNC x 1-1/2" deep threaded holes to the bosses on the load collar. Two 1/2" x 1-1/2" cap screws (PN 0983) and two 1/2" jam nuts (PN 3157), shown as items 5 and 6 below, are then used to provide a bearing point. Please refer to drawing 30001081 rev. 9 for complete specifications. This change is documented fully by ECN 084-0005.

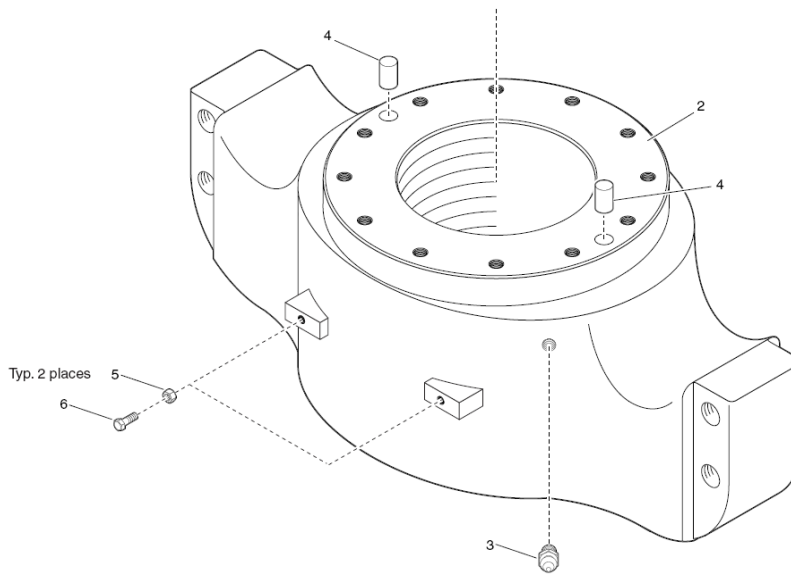

Figure 1 – Bolts added to load collar for stabilization

AFFECTED PRODUCT:

The affected products include all of 250T EMI 400 top drives that were manufactured before approximately November 15, 2006.

ACTION REQUIRED:

This modification is to be completed when an affected top drive is brought into a Tesco Service and Repair center for any routine maintenance or repair.

1. Drill and tap two holes in load collar as per Drawing 30001081 rev. 9.
2. Install bolts and jamb nuts as per illustration 13392 (and shown above in Figure 1) using Loctite 243.
3. Adjust depth of bolt to provide 1/16" space between bolt heads and grabber leg as shown in Figure 2 below, torque jam nut to 50 ft-lb.

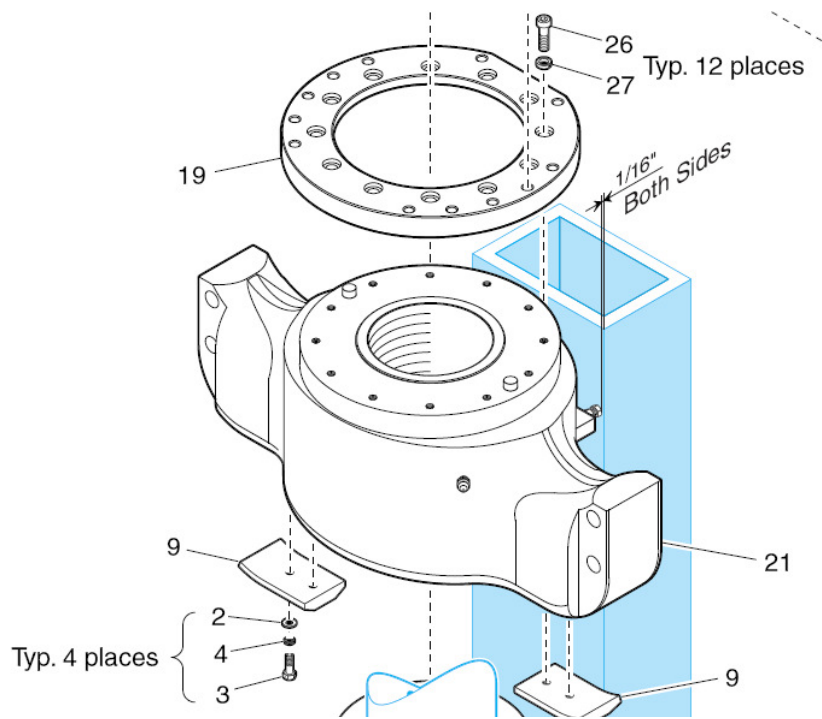

Figure 2 – Adjustment of bolt protrusion

Contact your local TESCO Parts and Service Center for further information regarding this bulletin and or supply of affected components noted above.