

# Change Bulletin

No: CB037

Rev: 0

Date: 21 May 2009

## Description: Change Seal installation for EMI 400 Gearbox Assembly



Tesco Corporation  
3993 W. Sam Houston  
Pkwy N.  
Suite 100  
Houston, Texas.77043  
Phone: (713) 359-7000  
[www.tescocorp.com](http://www.tescocorp.com)  
[www.tescoparts.com](http://www.tescoparts.com)

### BACKGROUND INFORMATION:

During gearbox assembly, it was noticed that tolerance stackup could result in the input shaft chamfer sitting on the edge of the seal which could cause leaks.

TESCO changed the seal retainer so that the seal is inserted from the top rather than the bottom (see Figure 1 and 2 below).

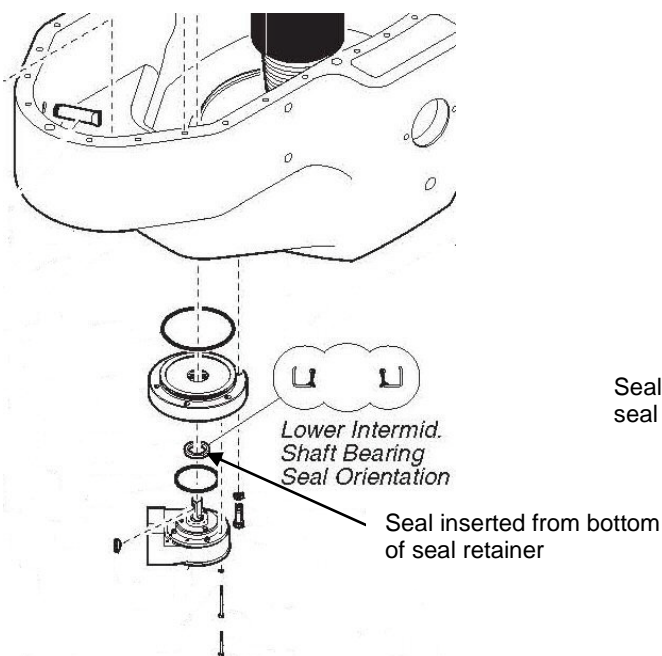

Figure 1: Seal Placement Before

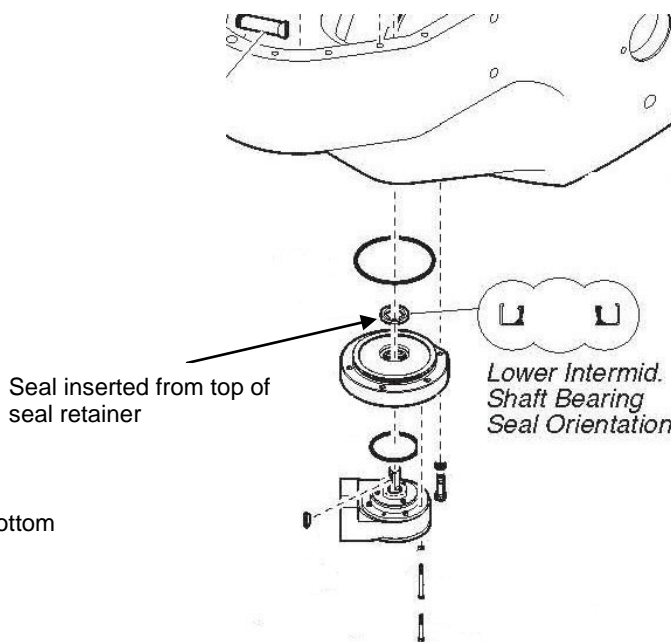

Figure 2: Seal Placement After

### AFFECTED PRODUCT:

EMI 400 Gearbox

### REFERENCE DOCUMENTS:

P/N 1130110 Gearbox,12.47:1 Ratio,H&P,250-EMI-400  
P/N 1130111 Gearbox,12.47:1 Ratio,w/o PH,H&P,150-EMI-400  
P/N 720752 Gearbox,10.96:1 Ratio,EMI-400  
P/N: 10333 Retainer,Lower,Bearing,Interm Shaft,Gearbox,EMI  
ECN-141-0094

### ACTION REQUIRED:

No action was required.

Contact your local TESCO Parts and Service Center for further information regarding this bulletin and or supply of affected components noted above.