

# Technical Bulletin

No: TB067

Rev: 0

Date: April 20, 2009

## Description: H&P Specific 150/250-EMI-400 Split Block Spreader and Support



Tesco Corporation  
6204 – 6A Street SE  
Calgary, AB. T2H 2B7  
Phone: (403) 692 5700  
[www.tescocorp.com](http://www.tescocorp.com)



### BACKGROUND INFORMATION:

A number of H&P specific 150 and 250 Ton EMI 400 split block assemblies were inspected and indications of cracks were found in the spreader bar and block guide welds (see Figures 1 and 2 for identification of affected parts). TESCO has reviewed the design and introduced a number of changes to improve the function of the affected parts; these include welding process changes for full penetration welds, the addition of radiographic and/or ultrasonic inspection of full penetration welds, changes to some of the fillet welds to make them full penetration welds and the addition of Wet Fluorescent Magnetic Particle Inspection (WFMPI) to all welds on these components. TESCO will provide replacements for the affected components.

### AFFECTED PRODUCT:

All affected parts fitted to H&P specific 150/250-EMI-400 Top Drive units, see tables and illustrations below:

#### H&P Specific 150-EMI-400 (Figure 1)

TESCO Part Number	Description
810205	Spreader, Machined, Split Block, 150T, EMI 400
810228	Support, Split Block, 150T, EMI 400

#### H&P Specific 250-EMI-400 (Figure 2)

TESCO Part Number	Description
810235	Split Block Assembly, 250EMI400, H&P
920034 & 920035	Support, Split Block 250T, EMI 400 (DS&ODS)
970072	Support, Split Block, Flex 4 Sub 3, EMI 400, H&P

810228  
Support, Split  
Block, 150T,  
EMI 400

810205  
Spreader, Split Block,  
150T, EMI 400,

810228  
Support, Split  
Block, 150T,  
EMI 400

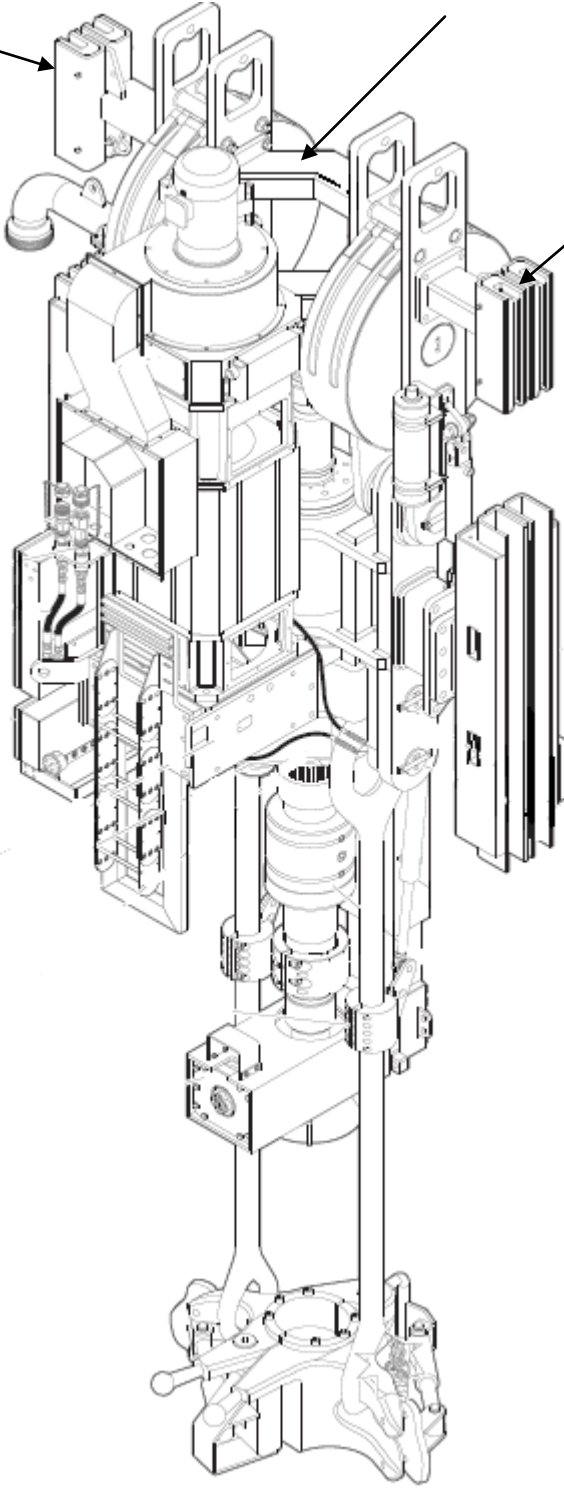

**Figure 1 – 150T EMI 400**

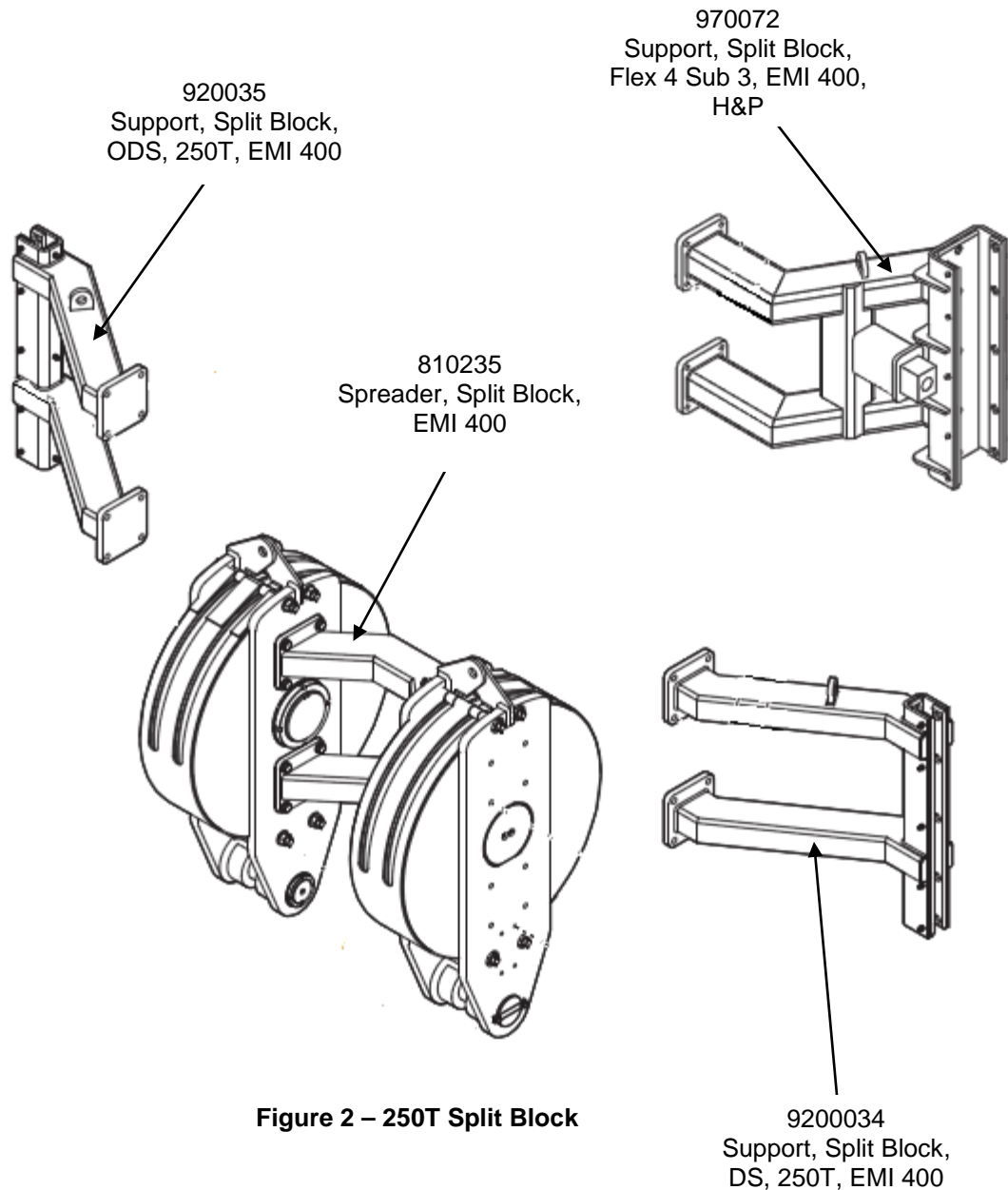

**Figure 2 – 250T Split Block**

**ACTION REQUIRED:**

Please contact your local TESCO representative to obtain replacement parts. In the event that a replacement cannot be implemented immediately, TESCO recommends that the inspection interval for these components be shortened to 60 days from the current 250 day cycle until the component can be replaced and/or a safety cable be fitted to prevent a dropped object incident in the event of a failure.

---

**Contact your local TESCO Parts and Service Center for further information regarding this bulletin and or supply of affected components noted above.**